

FOR LEASE

HISTORIC MICAH BUILDING

680 STATE ST
SALEM, OR 97301



OVERVIEW

Great combination of private offices and open office space for a conference table, reception area or additional workspace. Paid Street parking available around the building. Walking distance to Downtown, State Capitol, and Willamette University. Large conference rooms available to rent for day use for conferences/events.

HIGHLIGHTS

- 1,728 - 4,156 SF available; full service, less janitorial
- Built in 1929
- Located one block west of the Oregon State Capitol and is on the Cherriot transit bus line
- Tenant shall have access to large meeting room, when available, for an additional charge per use

Josh Kay | joshua@firstcommercialoregon.com
Tanner Morgan | tanner@firstcommercialoregon.com

503-364-7400 | 365 STATE ST, SALEM, OR 97301 | FIRSTCOMMERCIALOREGON.COM

All brokers listed above are licensed in the State of Oregon. The information contained herein has been obtained from the owner of the property or from other sources that we deem reliable. We have no reason to doubt its accuracy, but we do not guarantee it. All information is subject to change without notice.



FIRST COMMERCIAL
REAL ESTATE

FOR LEASE

HISTORIC MICAH BUILDING

SPACE AVAILABLE

TOTAL SPACE AVAILABLE
4,156 SF

LEASE RATE
\$1.75/SF/MO

LEASE TYPE
FULL SERVICE

ZONE
CENTRAL BUSINESS DISTRICT

SUITE 150

Space Available	2,428 SF
Lease Rate	\$1.75/SF/MO
Space Type	Office
Lease Type	Full Service
Zone	CB

6 Private offices with large area for conference table, additional work space or reception area. Can be combined with suite 180 for a total of 4,156 SF. Parking available in private parking lot for \$75/month.

SUITE 180

Space Available	1,728 SF
Lease Rate	\$1.75/SF/MO
Space Type	Office
Lease Type	Full Service
Zone	CB

Large open office space with a conference room, 1 private office and kitchen/break room. Can be combined with suite 150 for a total of 4,156 SF. Parking available in private parking lot for \$75/month.

FOR LEASE

HISTORIC MICAH BUILDING

PHOTOS
SUITE 150



503-364-7400 | 365 STATE ST, SALEM, OR 97301 | FIRSTCOMMERCIALOREGON.COM

The information contained herein has been obtained from the owner of the property or from other sources that we deem reliable. We have no reason to doubt its accuracy, but we do not guarantee it. All information is subject to change without notice.

FOR LEASE

HISTORIC MICAH BUILDING

PHOTOS
SUITE 180



503-364-7400 | 365 STATE ST, SALEM, OR 97301 | FIRSTCOMMERCIALOREGON.COM

The information contained herein has been obtained from the owner of the property or from other sources that we deem reliable. We have no reason to doubt its accuracy, but we do not guarantee it. All information is subject to change without notice.

HISTORIC MICAH BUILDING

FLOOR PLAN

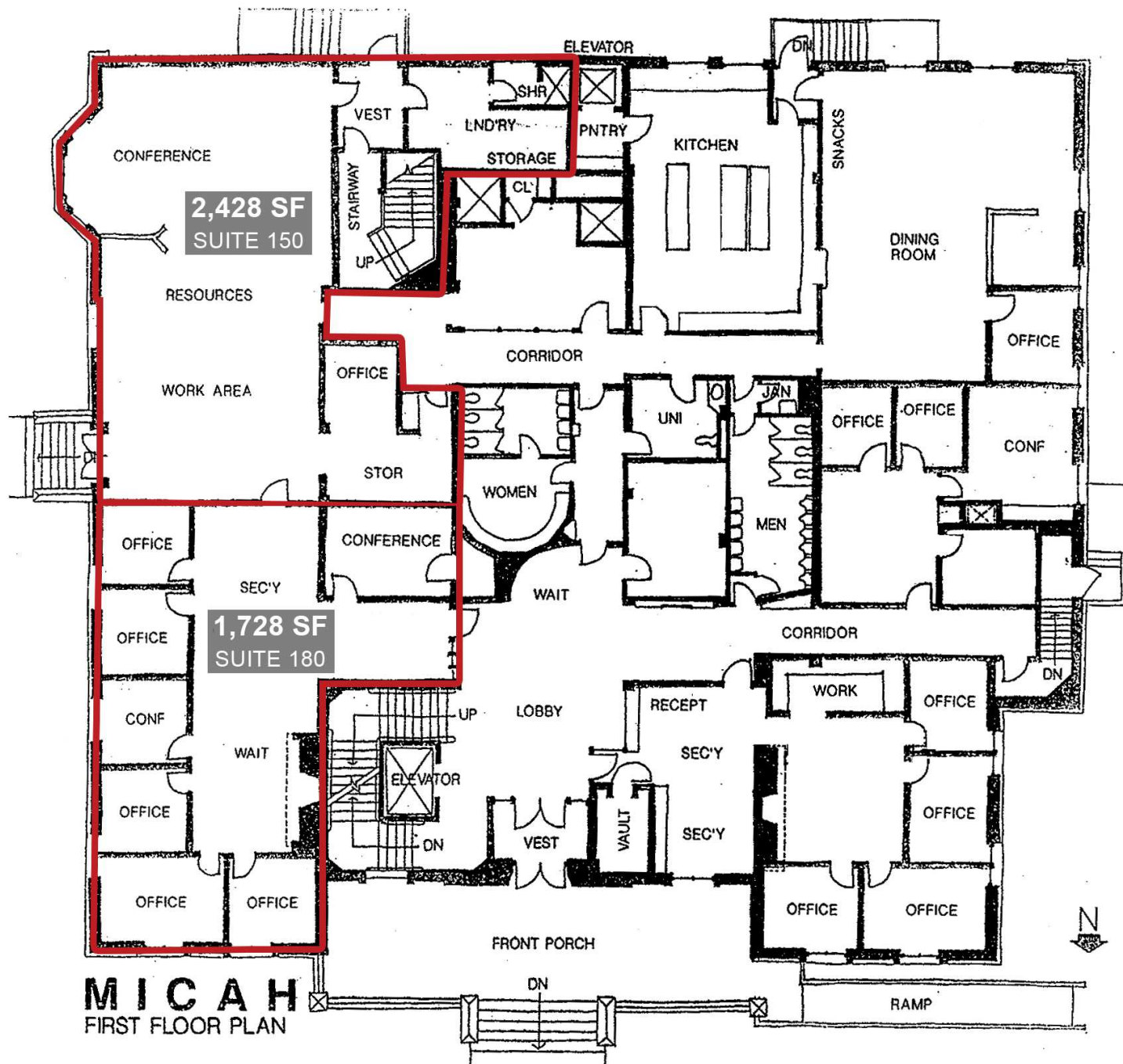

503-364-7400 | 365 STATE ST, SALEM, OR 97301 | [FIRSTCOMMERCIALOREGON.COM](https://firstcommercialoregon.com)

The information contained herein has been obtained from the owner of the property or from other sources that we deem reliable. We have no reason to doubt its accuracy, but we do not guarantee it. All information is subject to change without notice.